



UNIVERSITY OF WARWICK SCIENCE PARK

THE VENTURE CENTRE

The Venture Centre provides attractive serviced space, in a well-equipped environment for tech-based businesses to grow in an excellent location. The building offers office, laboratory and workshop space in a wide variety of sizes that are suitable for all stages of business.

Key Facts

Ideal for start-up / early stage businesses looking to grow

Short, flexible leases ranging from one to three years

Office space ranging from 240 ft² (22 m²) to 1,149 ft² (106 m²)





The Venture Centre: floor plan & unit sizes

The Venture Centre provides extensive business services including reception, telephone answering, post franking and meeting rooms. Units range from 240 ft² (22 m²) to 1,149 ft² (106 m²) and are available on short flexible leases of one to three years according to individual circumstances.

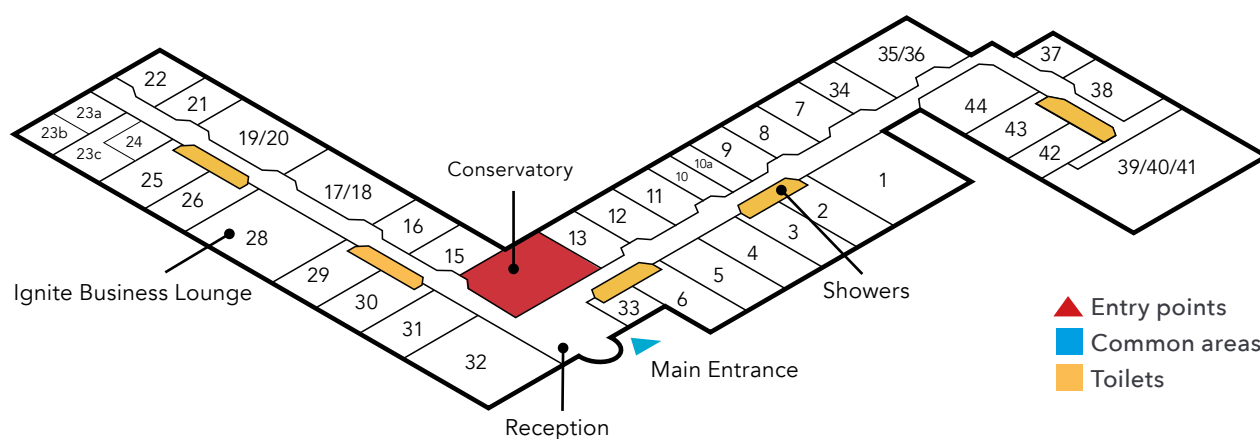

Unit	ft ²	m ²
1	1,149	106
2	691	64
3	691	64
4	755	70
5	755	70
6	685	64
7	409	38
8	435	40
9	273	25

Unit	ft ²	m ²
10	278	26
10a	260	24
11	430	40
12	435	64
13	430	40
15	297	28
16	430	40
19/20	865	80
21	432	40

Unit	ft ²	m ²
22	433	40
23a	268	25
23b	380	35
23c	453	42
25	700	65
26	700	65
28	1,474	137
29	600	56
30	700	65

Unit	ft ²	m ²
33	320	30
34	392	36
35/36	860	80
37	473	44
38	732	68
39/40/41	2,890	268
42	595	55
43	645	60
44	882	82



024 7632 3000
more-info@uwsp.co.uk
www.warwicksciencepark.co.uk

University of Warwick Science Park,
The Venture Centre, Sir William Lyons Road,
Coventry, CV4 7EZ

Carter Jonas

Alex Tross
07789 027 191
alex.tross@carterjonas.co.uk

Giles Garbutt
07977 915 791
giles.garbutt@carterjonas.co.uk