



## UNIVERSITY OF WARWICK SCIENCE PARK

# SOVEREIGN COURT

Sovereign Court consists of two buildings each with up to four individually accessed units. Situated adjacent to the University of Warwick, Sovereign Court offers high quality accommodation ideally suitable for tech-based businesses.

### Key Facts

Two individual, two storey buildings

High quality, adaptable office space

Individual premises of 2,000 ft<sup>2</sup> (186 m<sup>2</sup>) and 3,000 ft<sup>2</sup> (279 m<sup>2</sup>)







## Sovereign Court: floor plan & unit sizes

Sovereign Court One and Two are two storey buildings with lift access to the first floor. All ground floor units have direct access to the outside. Each building consists of four units with sizes ranging from 2,000 ft<sup>2</sup> (186 m<sup>2</sup>) to 3,000 ft<sup>2</sup> (279 m<sup>2</sup>).

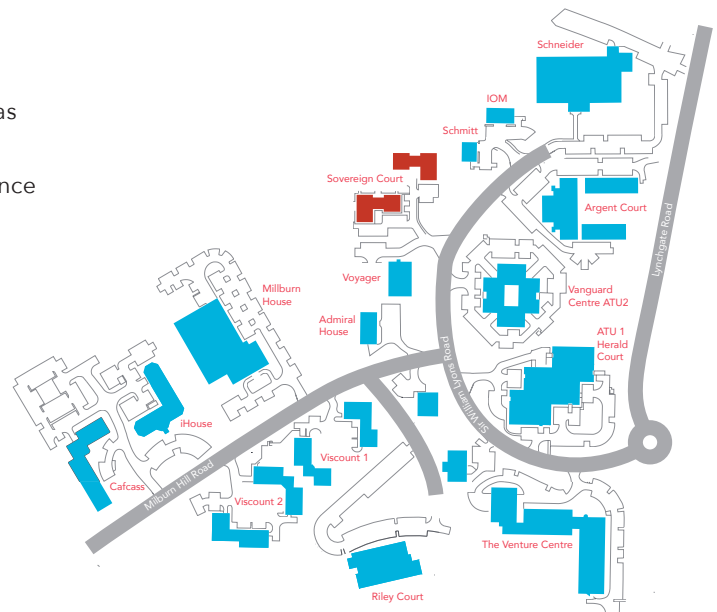
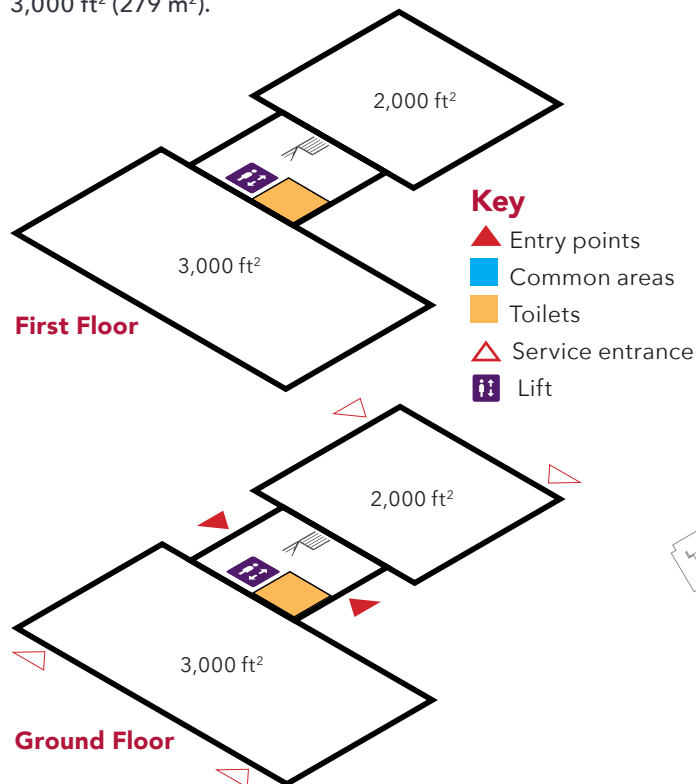

For further information call **024 7632 3000**  
[more-info@uwsp.co.uk](mailto:more-info@uwsp.co.uk)  
[www.warwicksciencepark.co.uk](http://www.warwicksciencepark.co.uk)

University of Warwick Science Park,  
 The Venture Centre, Sir William Lyons Road, Coventry CV4 7EZ

UNIVERSITY OF WARWICK  
 SCIENCE PARK